

SSA Assist Lift

Loading Group | up to F900

Special range of access covers

Operation Instructions

Single & Two Part

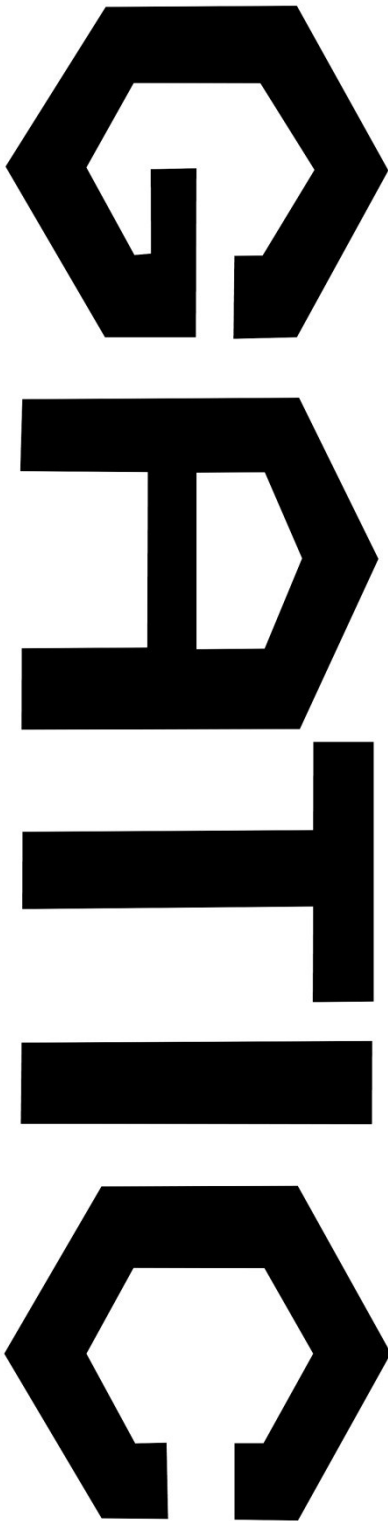

Important Information

Please read the following information before operating the covers.

All GATIC Assist Lift covers must be adequately, solidly and continuously supported to a degree sufficient for the designed load conditions in each particular case. Because of the diversity of site conditions it is not possible to give precise instructions for each application but the following details will serve as a guide to operation in most cases.



GATIC 'Assist Lift' covers are also 'Assist Close'. It is imperative that the covers are opened & closed with extreme caution & assistance during and after the installation as the closing force will differ depending on cover and setup.

The following operation instructions are suitable for Single and Two Part spring assist cover assemblies.

1. The Cover

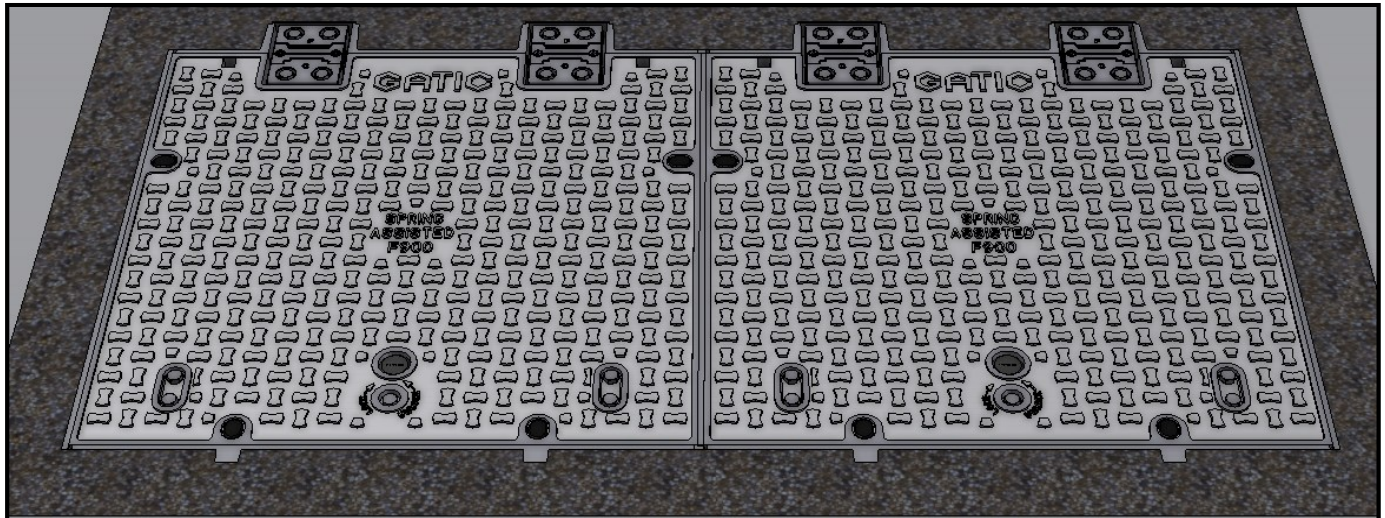

Rubber Bung

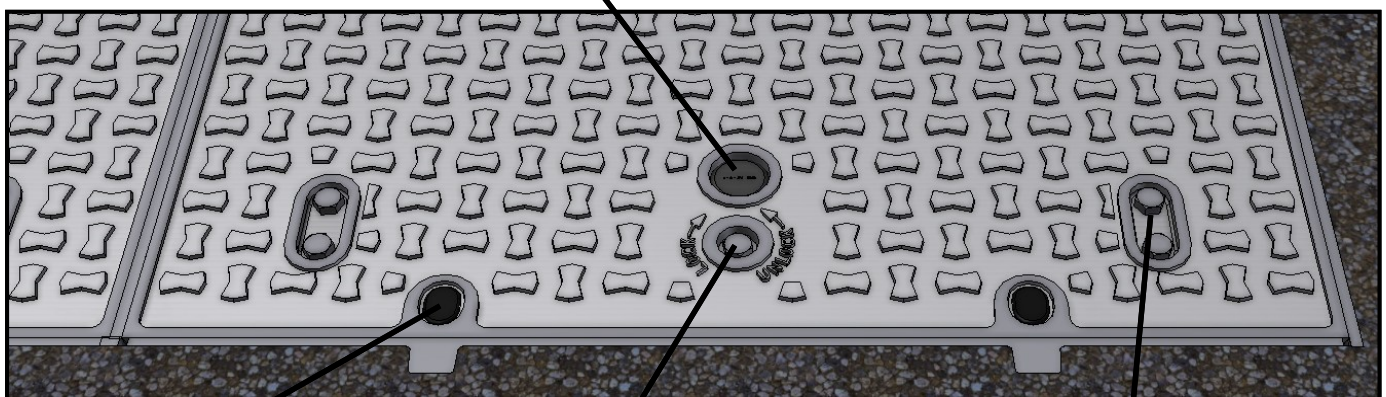

Keyway Plugs

Cover Locking Bolt

Bracket Bolt Recess

2. Remove the Nylon Keyway Plugs

Carefully prise open and remove the keyway plugs to expose the Keyways. Store the Plugs in a safe and secure location.

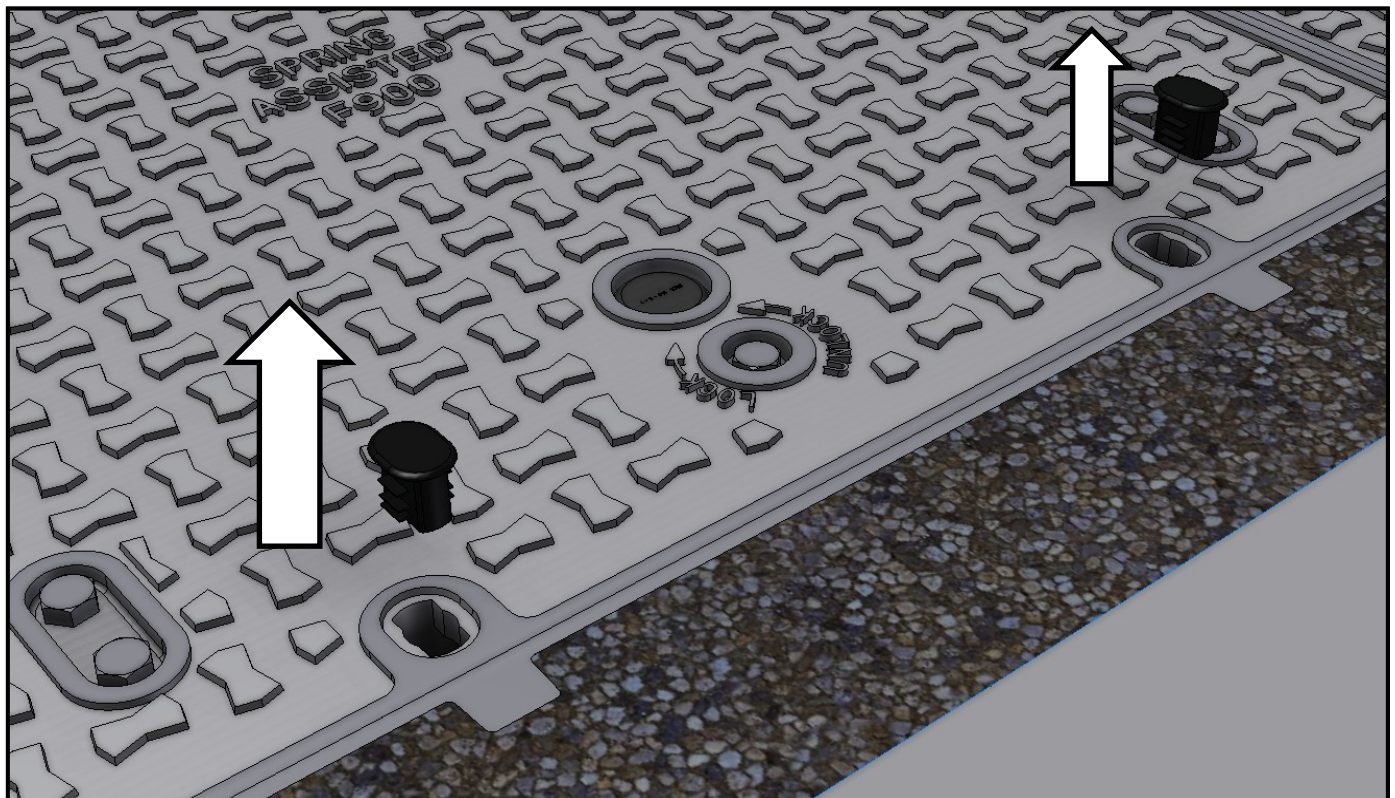
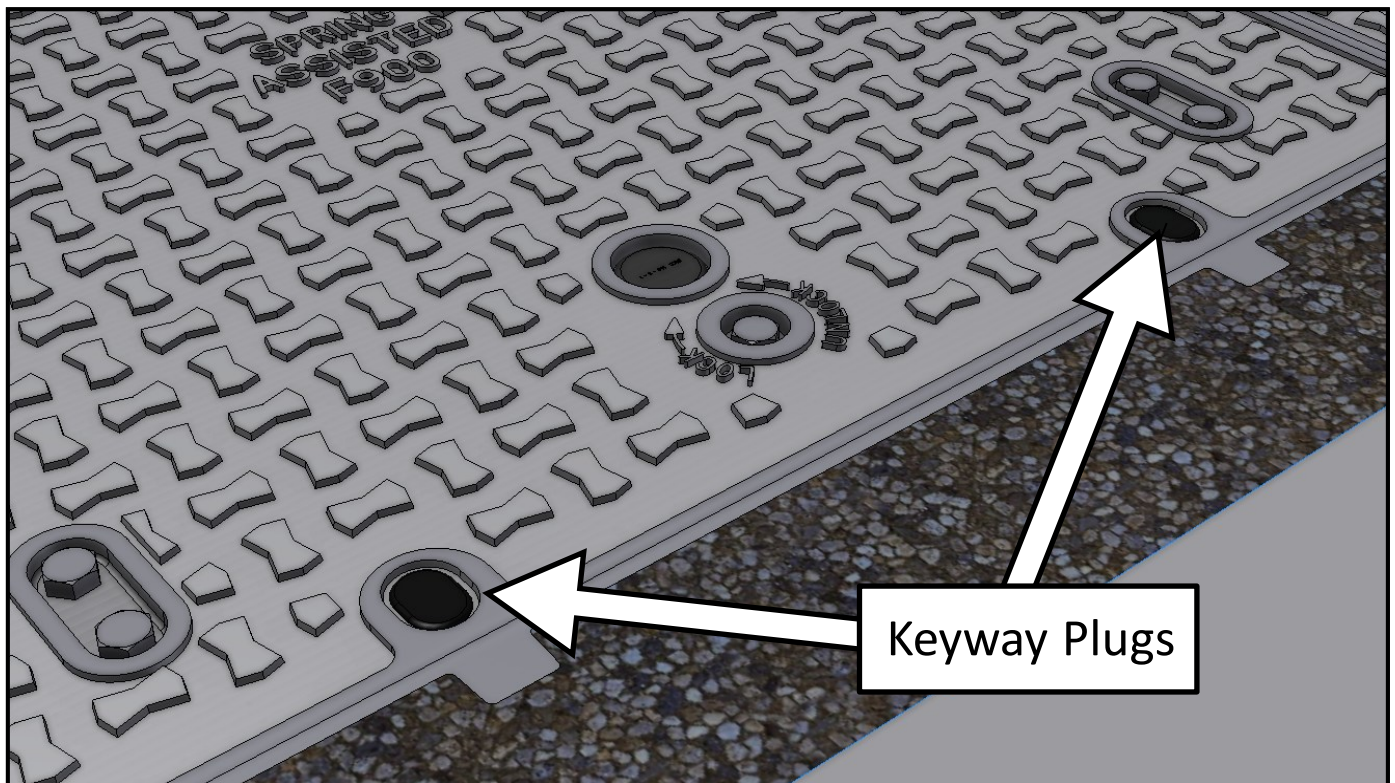

3. Short Handle Lifting Keys

GATIC Short handle lifting keys are used to open GATIC 'Assist Lift' covers. They are design specifically for Gatic covers. Do not use any other lifting key unless approved by GATIC.

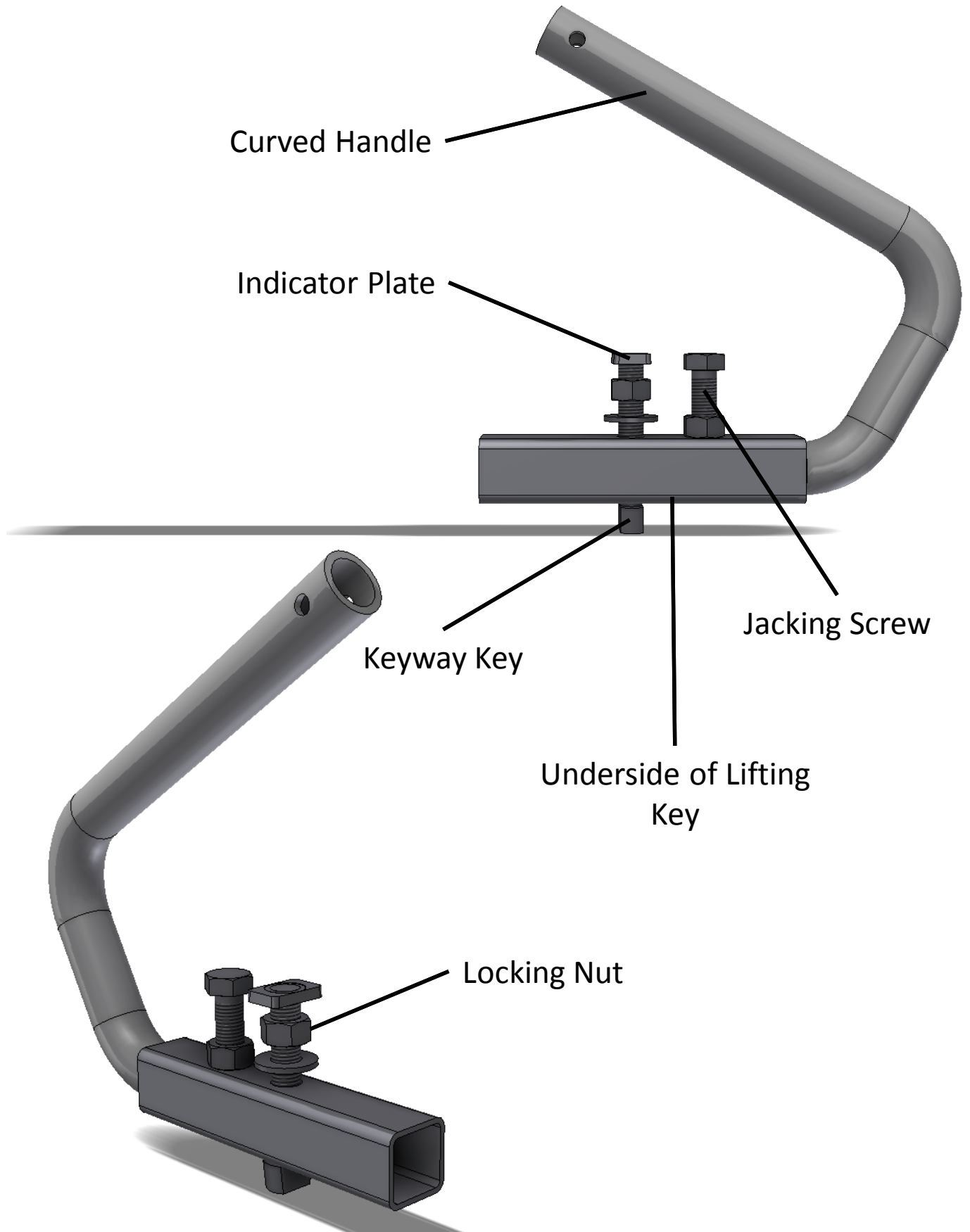

4. Attach the Lifting Keys

1. Securely attach the lifting keys into one of the keyways at the front of the cover. Ensure the jacking bolt is at the front of the cover and that its unscrewed and not proud on the underside of the locking key.
2. Rotate the indicator plate 90 degrees. This will engage the key in the keyway.
3. Using the spanner provided, rotate the locking nut clockwise until the lifting key is secured to the cover.

Please refer to Gatic brochure for additional information on lifting key installation.

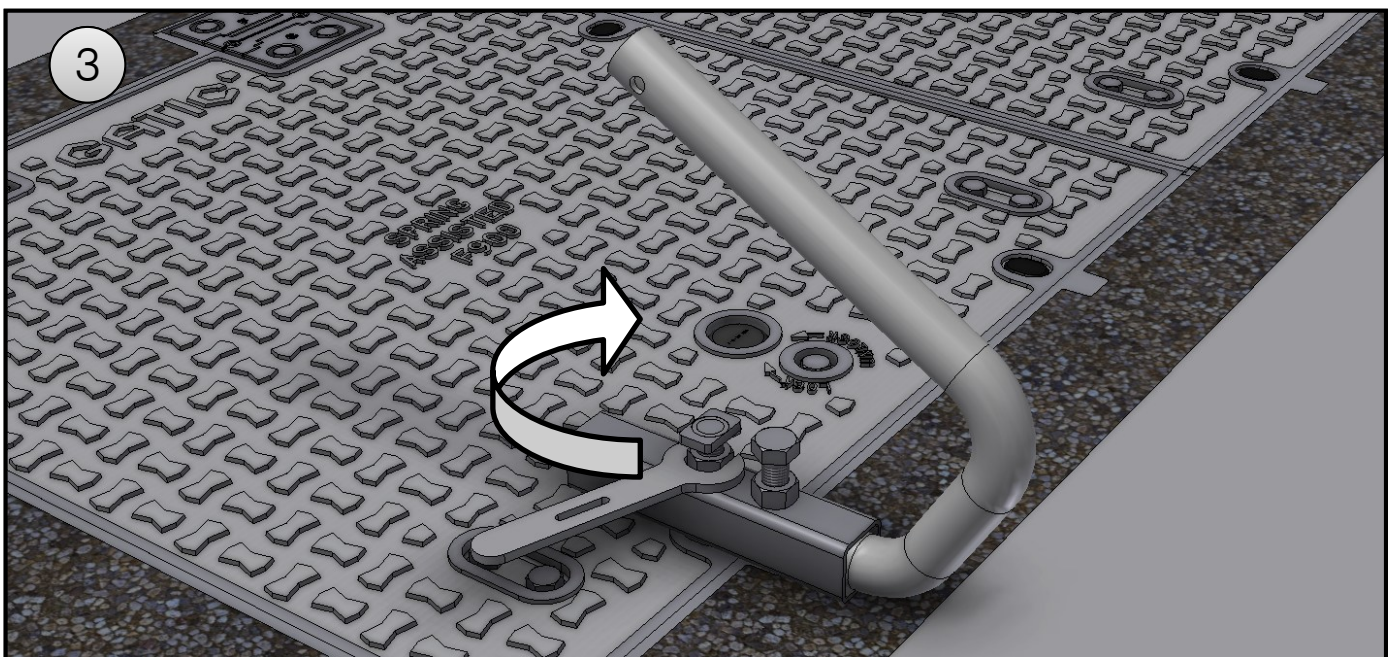
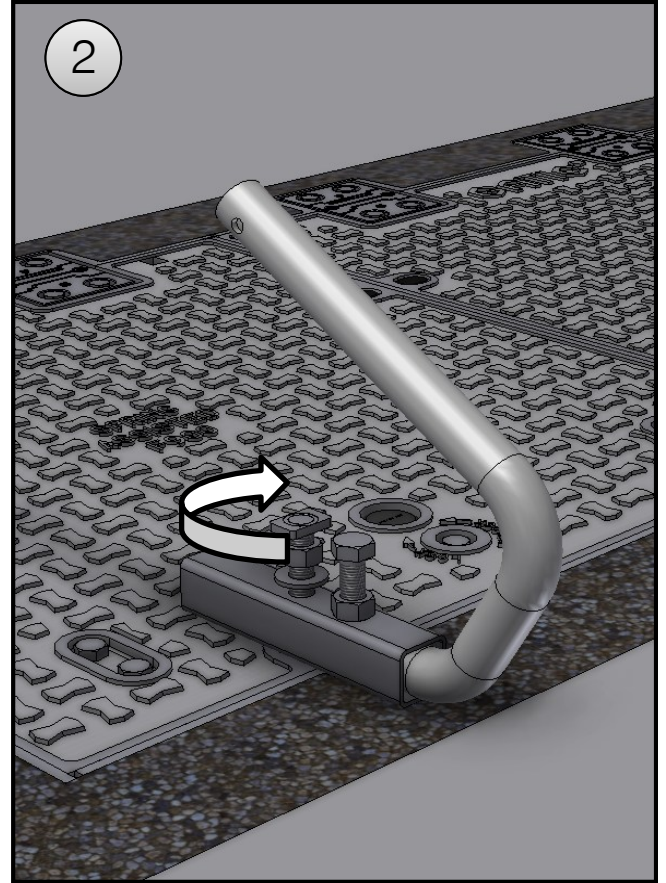
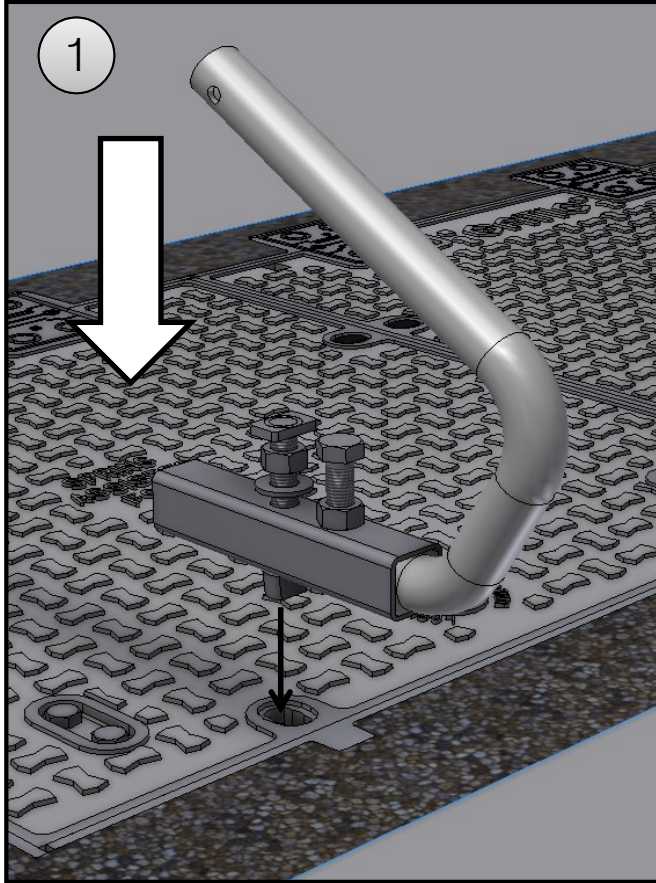

5. Attach Second Lifting Key (If Required)

Once the first short Handle Lifting Key is attached to the cover, the other lifting key can be attached to the keyway. Use the same procedure as in instruction 4.

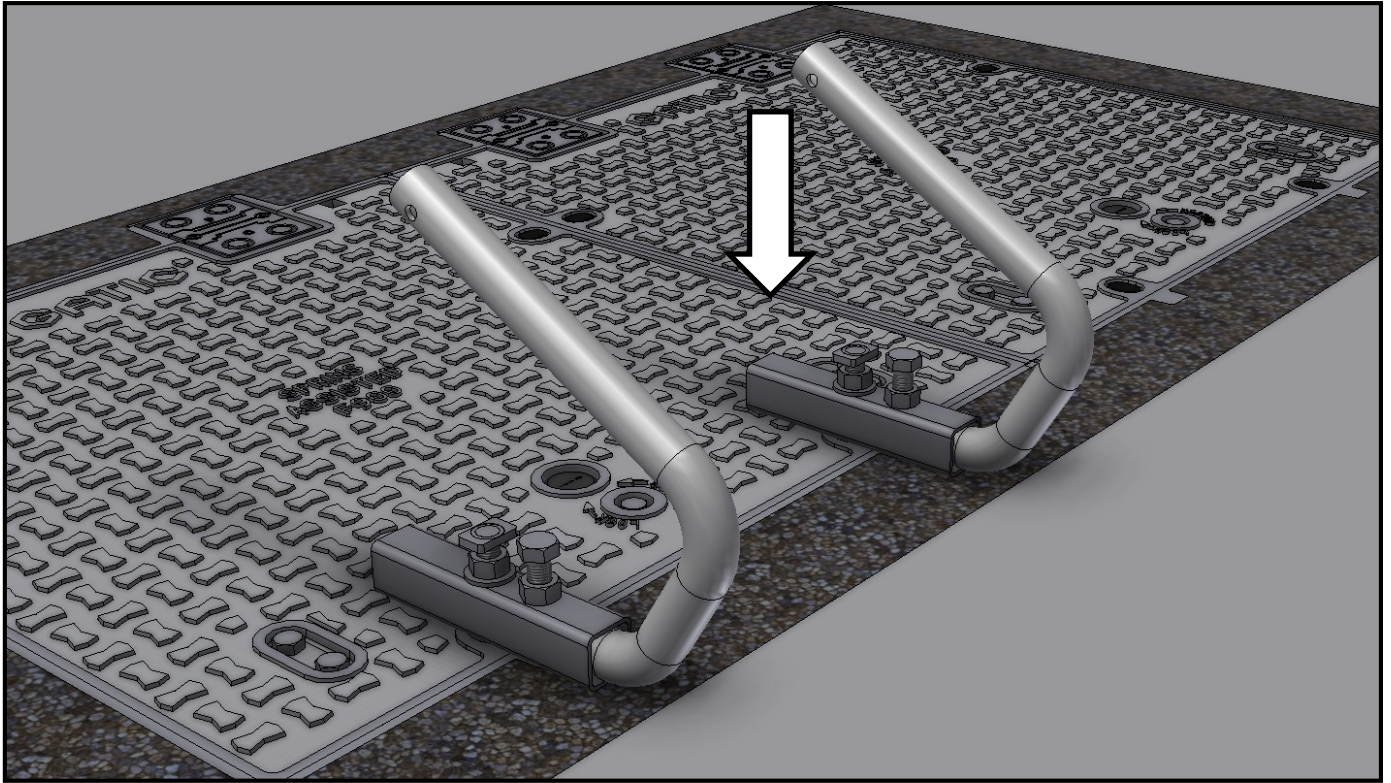

6. Loosen the Locking Bolt

Using the Tommy Bar provided, unlock the cover locking bolt. Turn the Tommy Bar anti-clockwise until it stops.

⚠ CAUTION Do not remove the locking bolt from the Cover

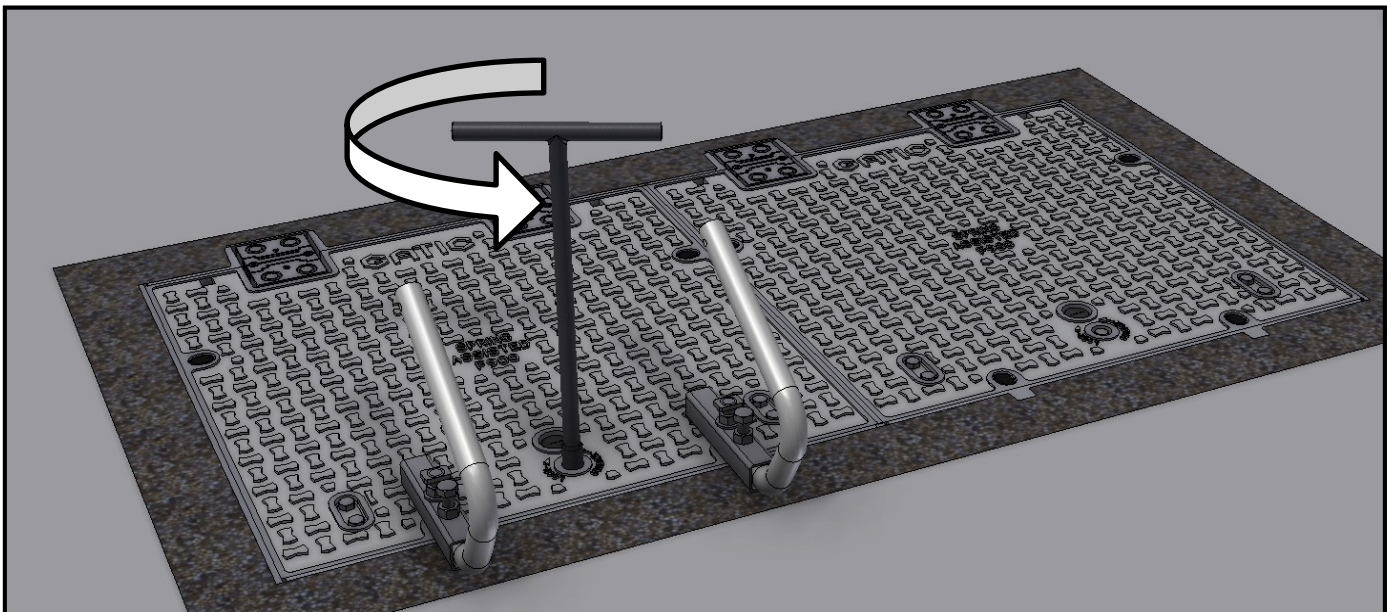

7. Break The Seal

Rotate the Jacking Screw on the Short Handle Lifting Key with the spanner supplied. The Jacking Screw will push against the pad on the front bar. Keep rotating the Jacking Screw until the seal breaks.

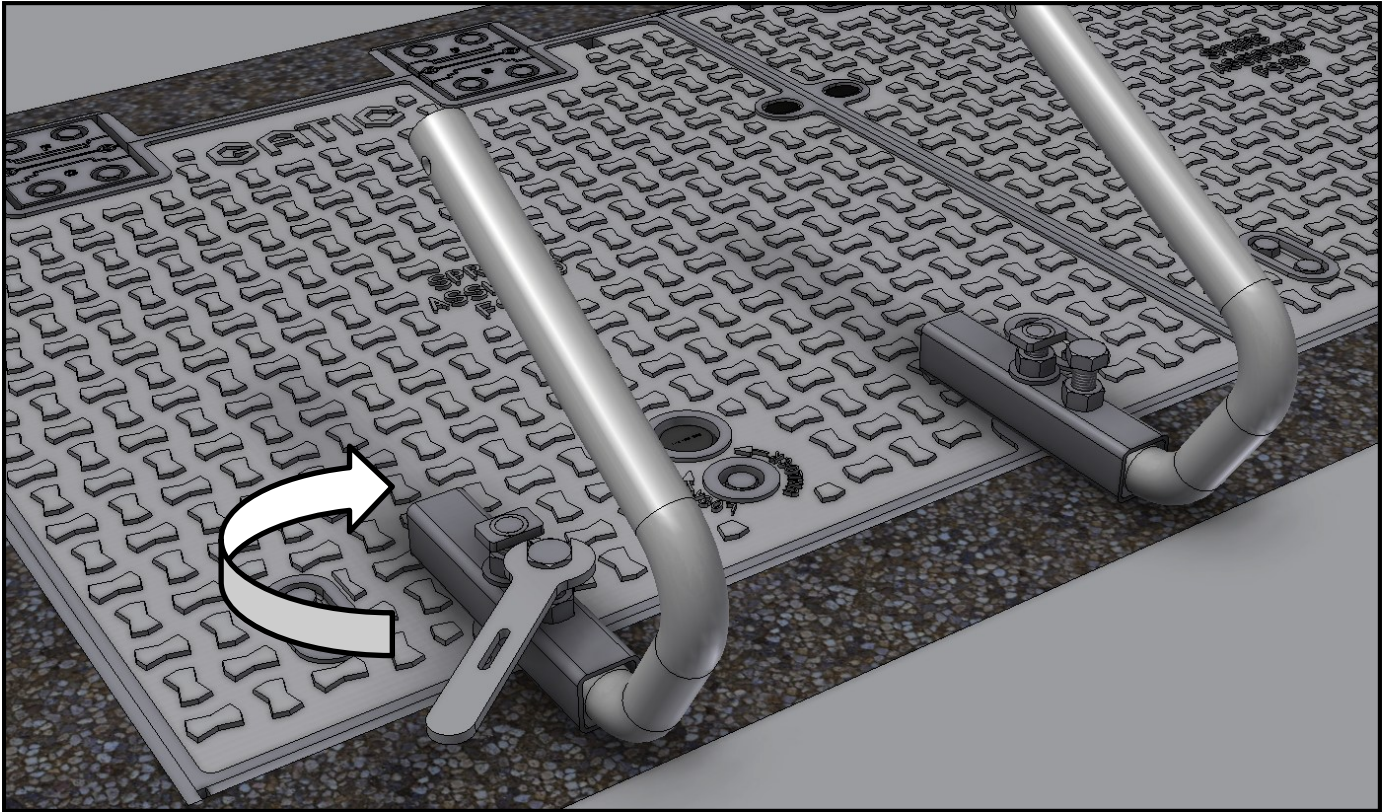

Once the seal has broken, the Slam Latch will prevent the cover from opening.

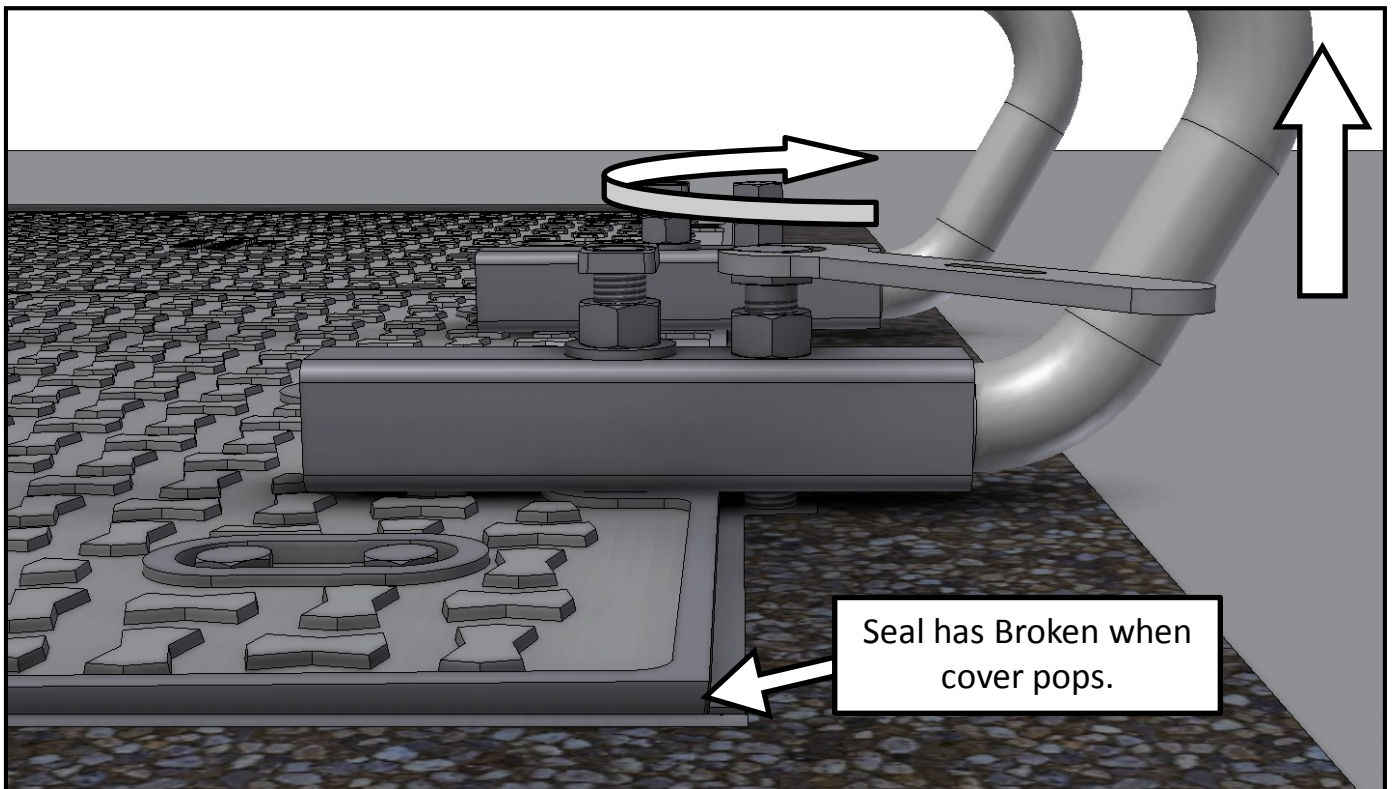

8. Removing the Rubber Bung

Carefully prise and remove the rubber bung and lay on top of the cover.

⚠ CAUTION Care must be taken not damage the bung.

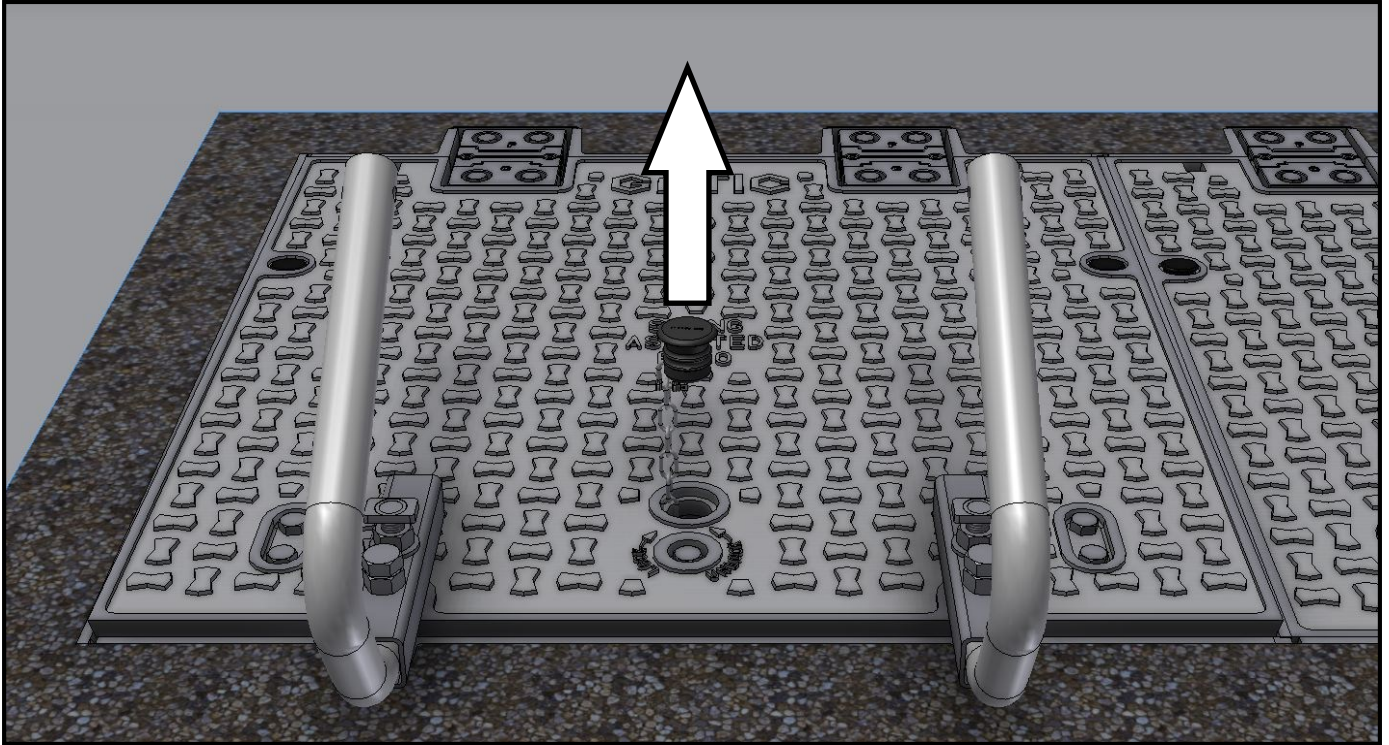

The chain attached to the rubber bung prevents it from being misplaced.

⚠ CAUTION Care must be taken not damage the chain when left on top of the cover.

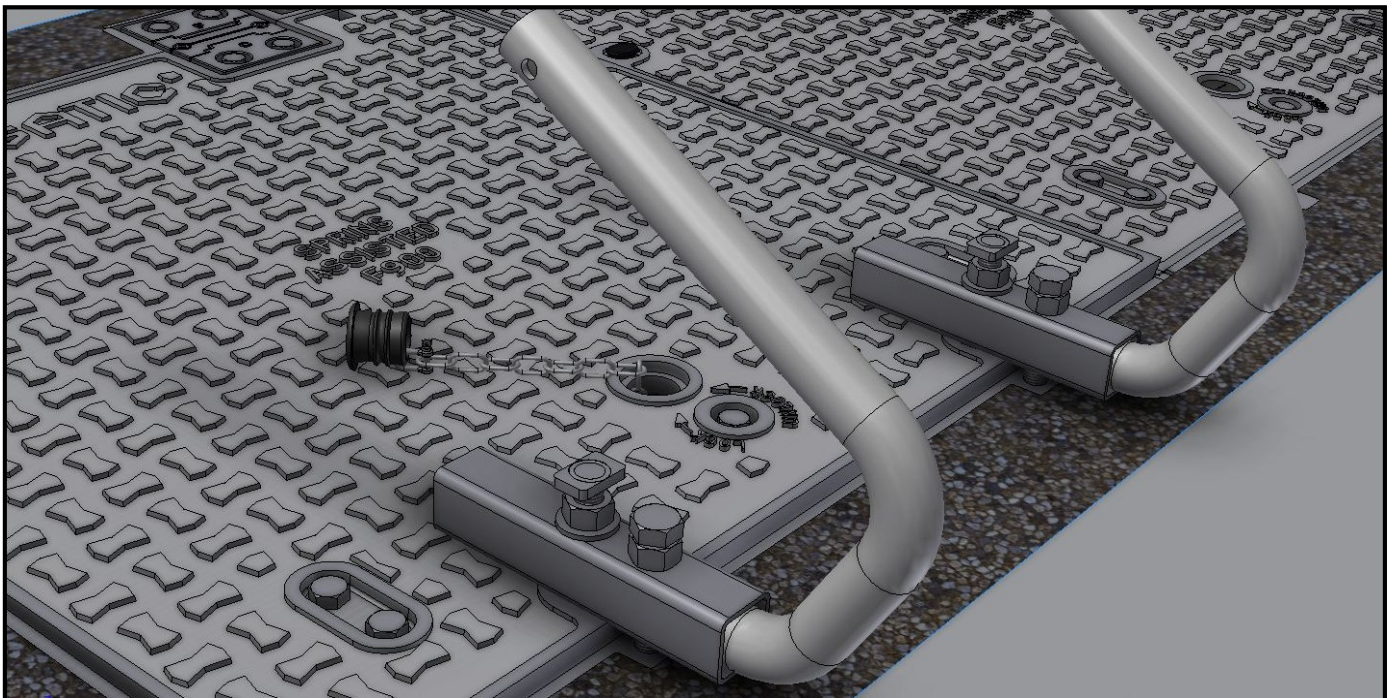

9. Operating the Slam Latch & Opening the Cover

Insert the Tommy Bar provided through the cover and into the recess in the slam latch mechanism below. Rotate the key towards the front of the cover to release the slam latch mechanism. This will disengage the slam latch and allow the cover to open.

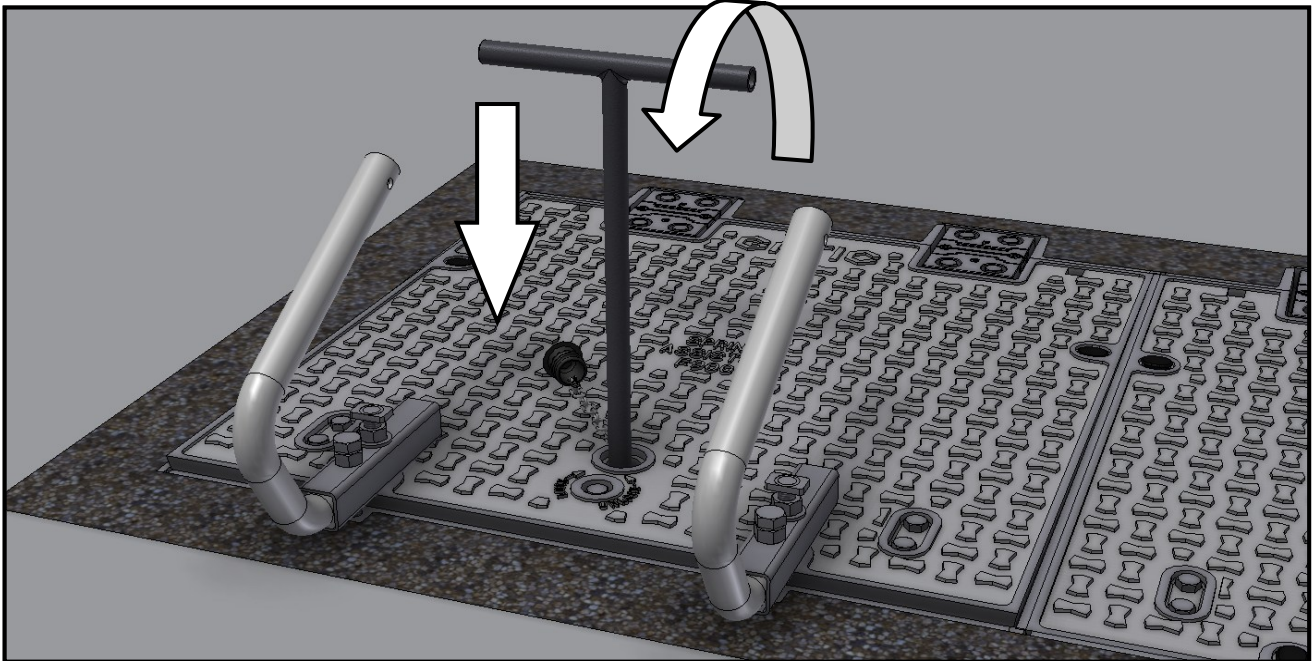

Whilst the Slam Latch mechanism is still levered open, use the lifting handles to lift the cover. After the cover has opened and has cleared the frame, the Tommy bar can be removed.

WARNING! *Ensure the clear opening is clear and free as the cover may close with force if dropped.*

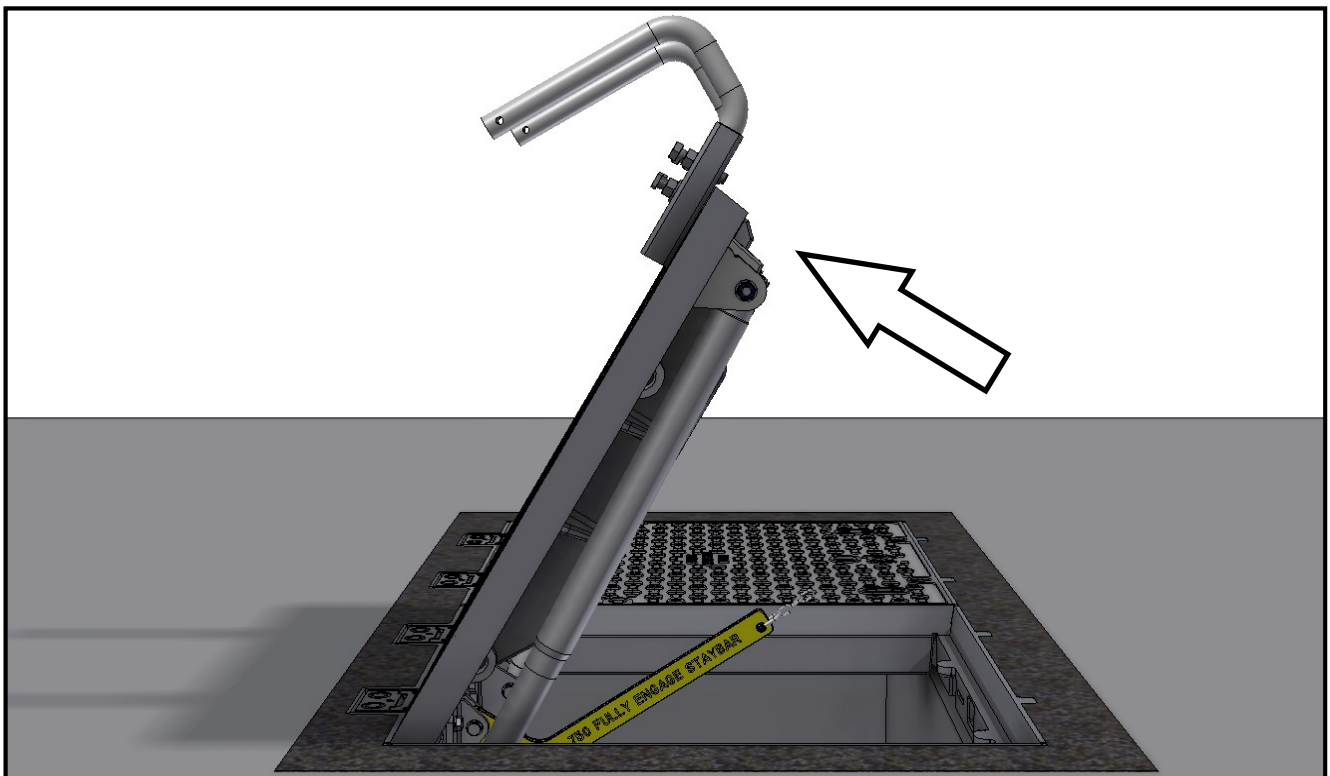

10. Engage the Stay Bar

Once the cover has been lifted open fully, the Stay Bar will need to be manually engaged. The Stay Bar should be obstructing the clear opening - this is to prompt users to engage the Stay Bar before entering. Use the chain to rotate the Stay Bar into position. When the Stay Bar rotates upright it will drop and engage into the bracket.

WARNING! Open the cover and MANUALLY engage the Stay Bar. ENSURE the Stay Bar has fully dropped into the bracket. Failure to do this may cause serious injury.

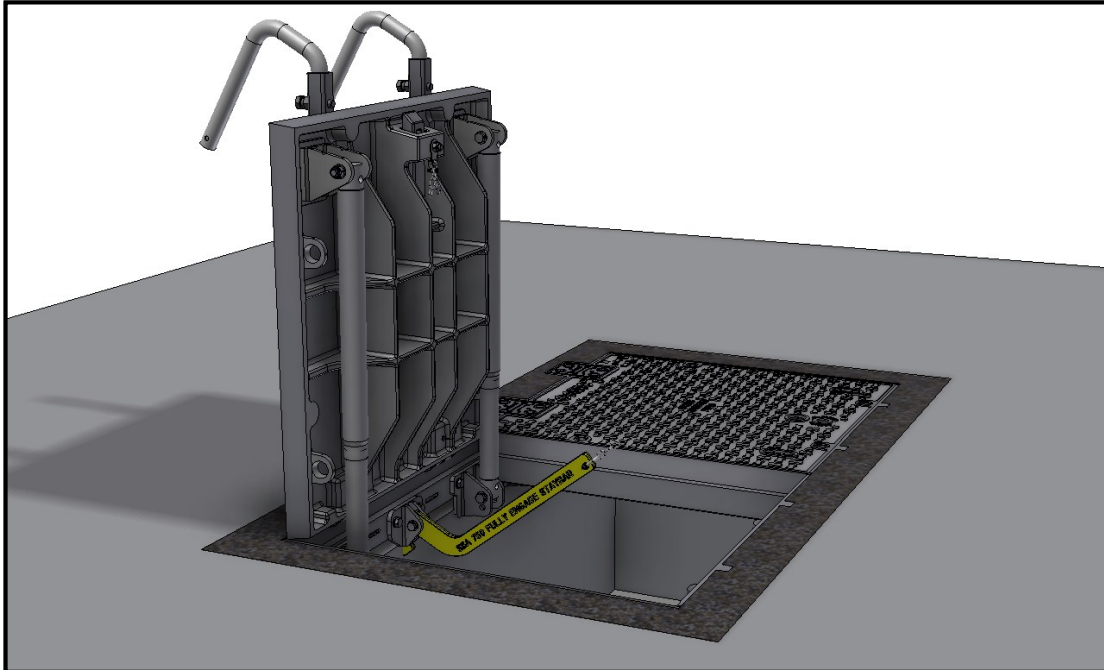

WARNING! MANUALLY engage the Stay Bar. ENSURE the stay bar has fully dropped into the bracket. Failure to do this may cause serious injury.

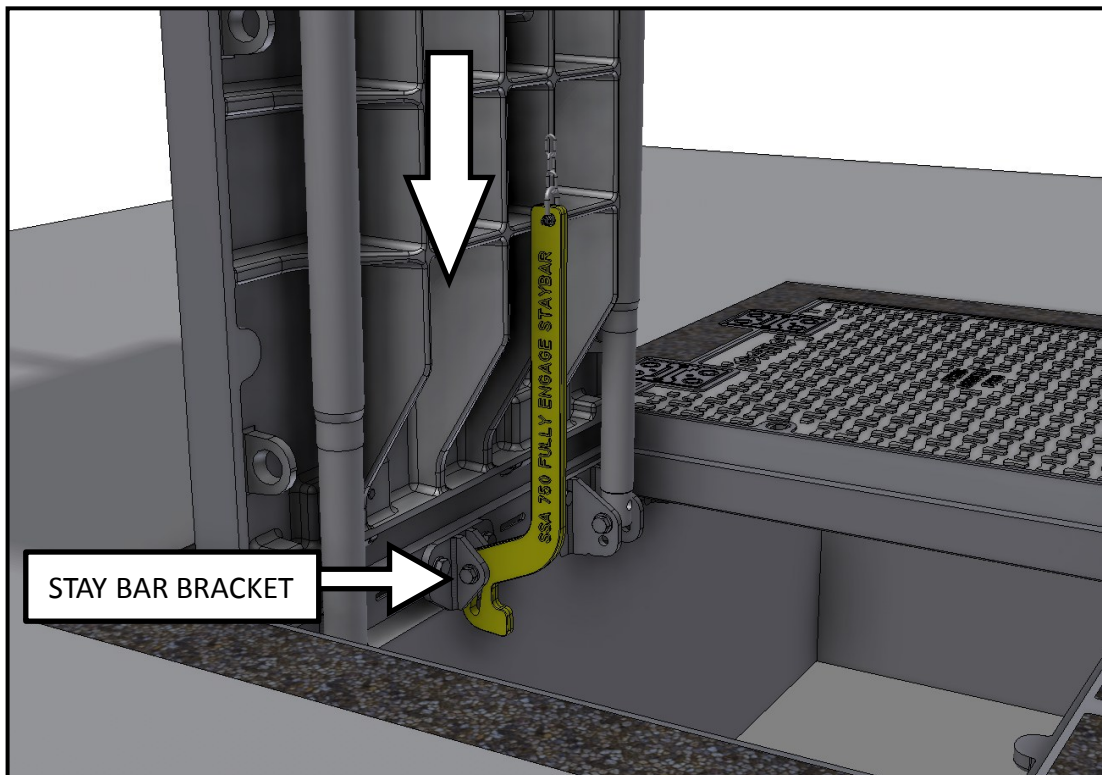

11. Multiple Covers (If Applicable)

If more than one cover is required to be opened, use the previous steps to open the covers.



Removing the Centre Bar (If Applicable)

The centre bars can be removed if more than one cover is required to be opened in a multiple unit. The Centre Bar is removed by simply lifting out of the frame. To replace, ensure the Centre Bar is located back onto the alignment lugs.

WARNING! *The Centre Bar will be greasy and heavy. Be careful when removing/replacing the Centre Bar to prevent injury.*

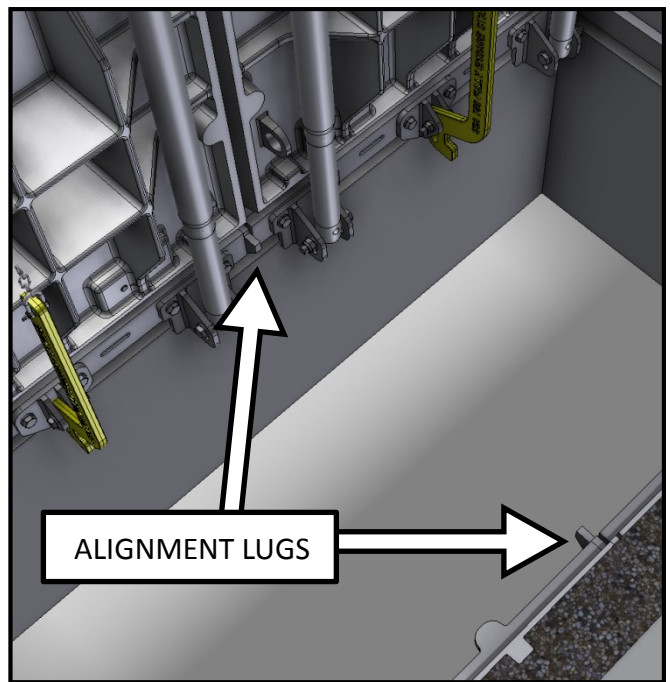
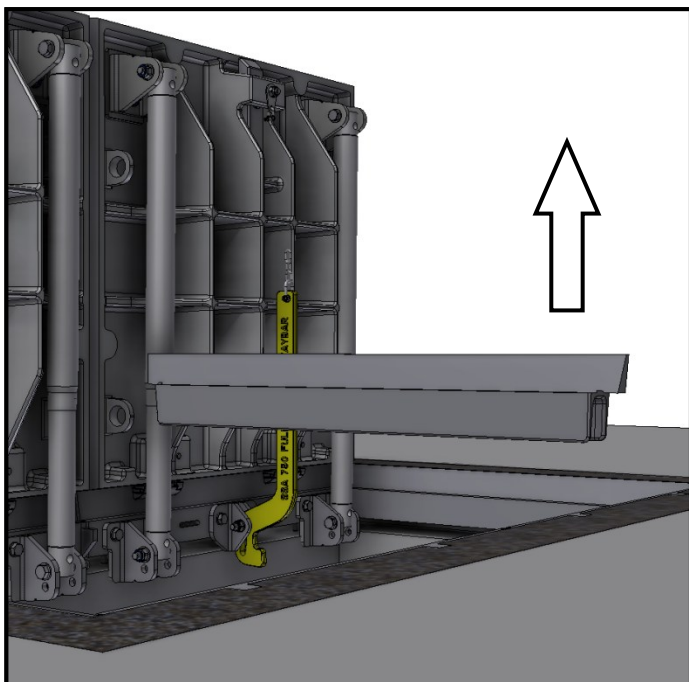

12. Clean & Grease All Seating's

Remove any debris that may be sitting on the seating faces. Apply a good quality graphite based grease to all the seating faces on the cover and frame to maintain a watertight fit.

WARNING! Failure to remove debris from the seating faces may seriously damage the hinges.

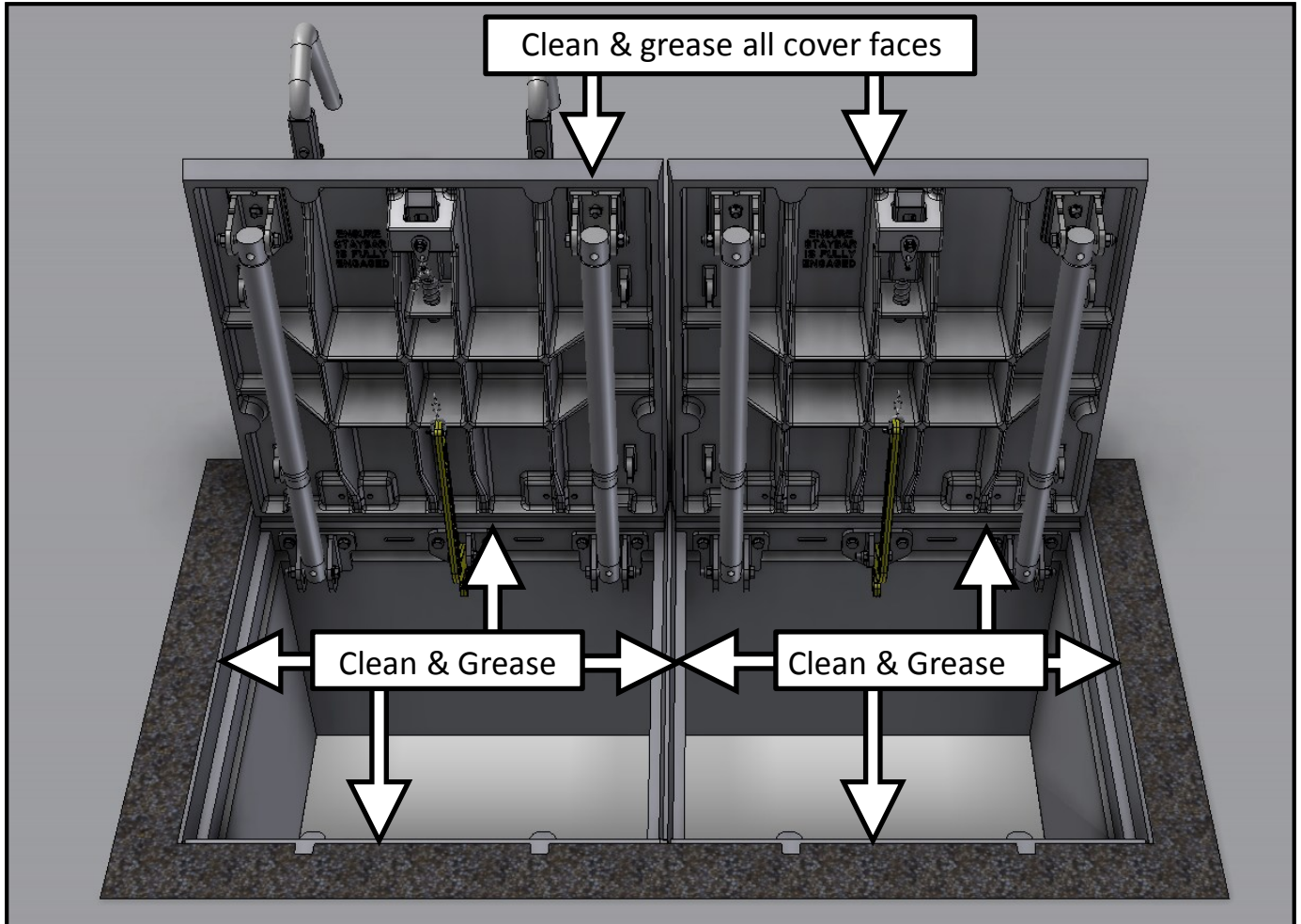

13. Unscrew the Jacking Bolts

Before closing the cover make sure the jacking bolt on the lifting key has been screwed back in as the cover will not close properly if it is protruding.

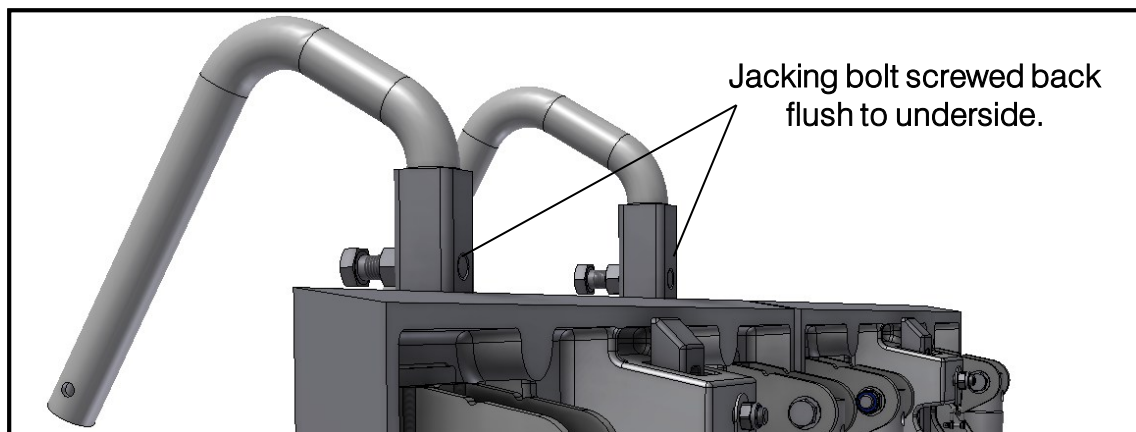

14. Disengage the Stay Bar

Push the cover back slightly to take the weight of the Stay Bar. Lift the Chain to disengage the Stay Bar.

WARNING! *Be careful when disengaging the Stay Bar as the cover may want to close.*

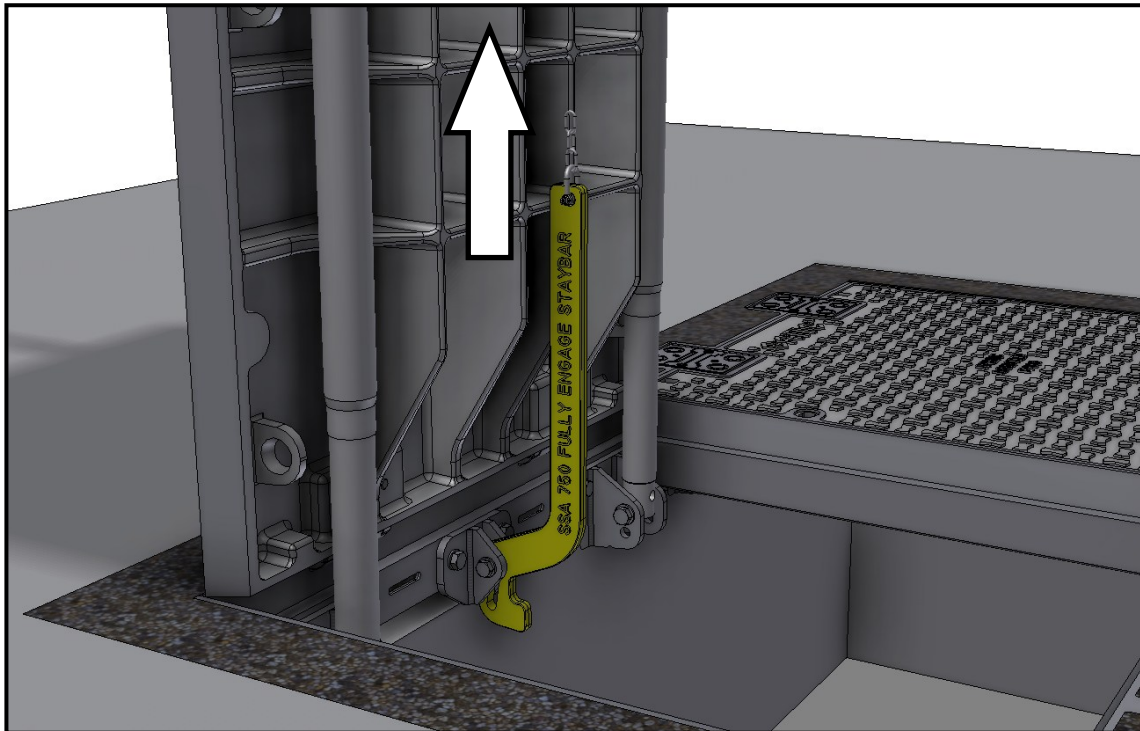

15. Close the Cover

Whilst still lifting the Stay Bar chain, use the lifting keys to carefully close the cover. Do not allow the cover to slam close.

WARNING! *Ensure the Stay Bar has been fully disengaged when closing the cover. Take care when closing the cover as this will prevent serious injury.*

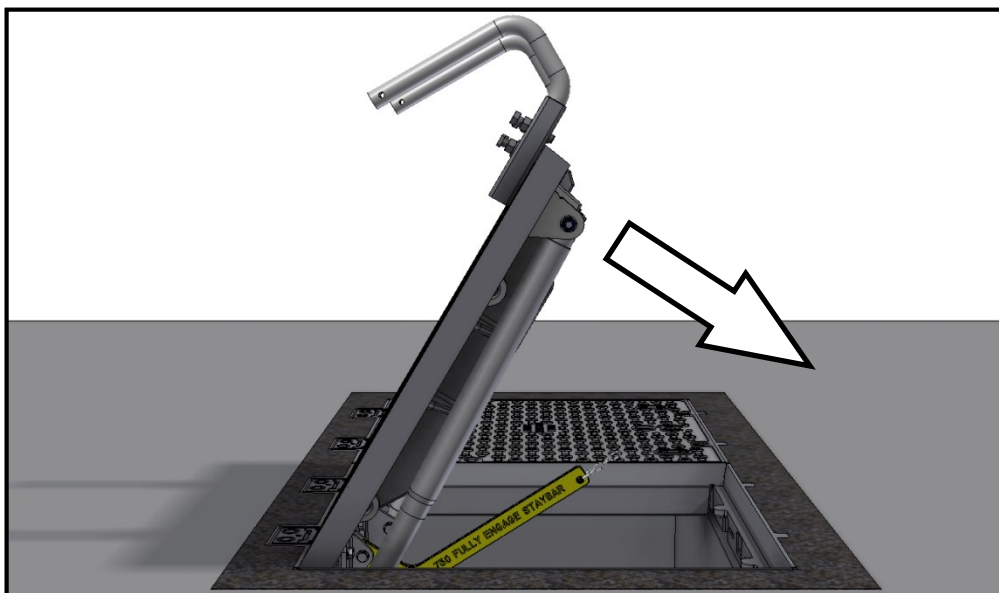

When the cover is closed ensure the slam latch has engaged preventing the cover from re opening. Don't worry if the cover dose not sit flush to the frame at this point.

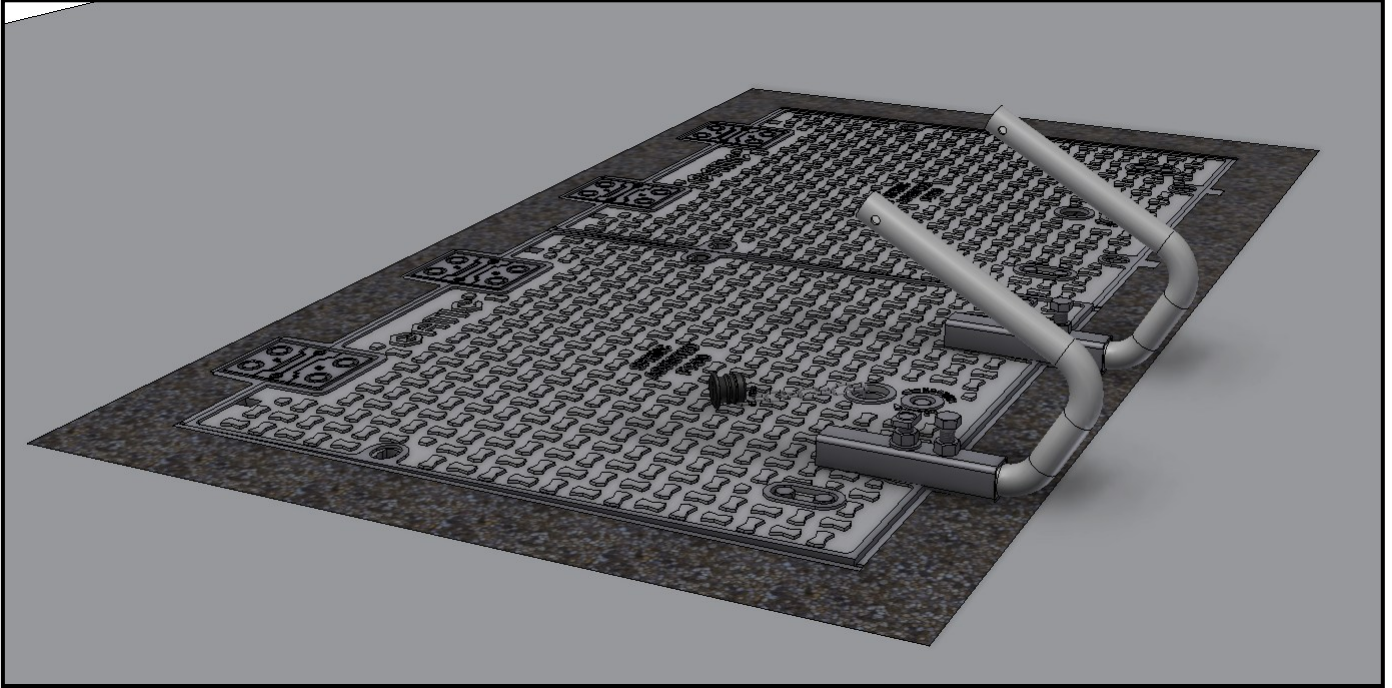

16. Tighten the Locking Bolt

Tighten the locking bolt clockwise using the Tommy Bar until the cover is flush with its frame. This will ensure that the cover is seating correctly and is watertight.

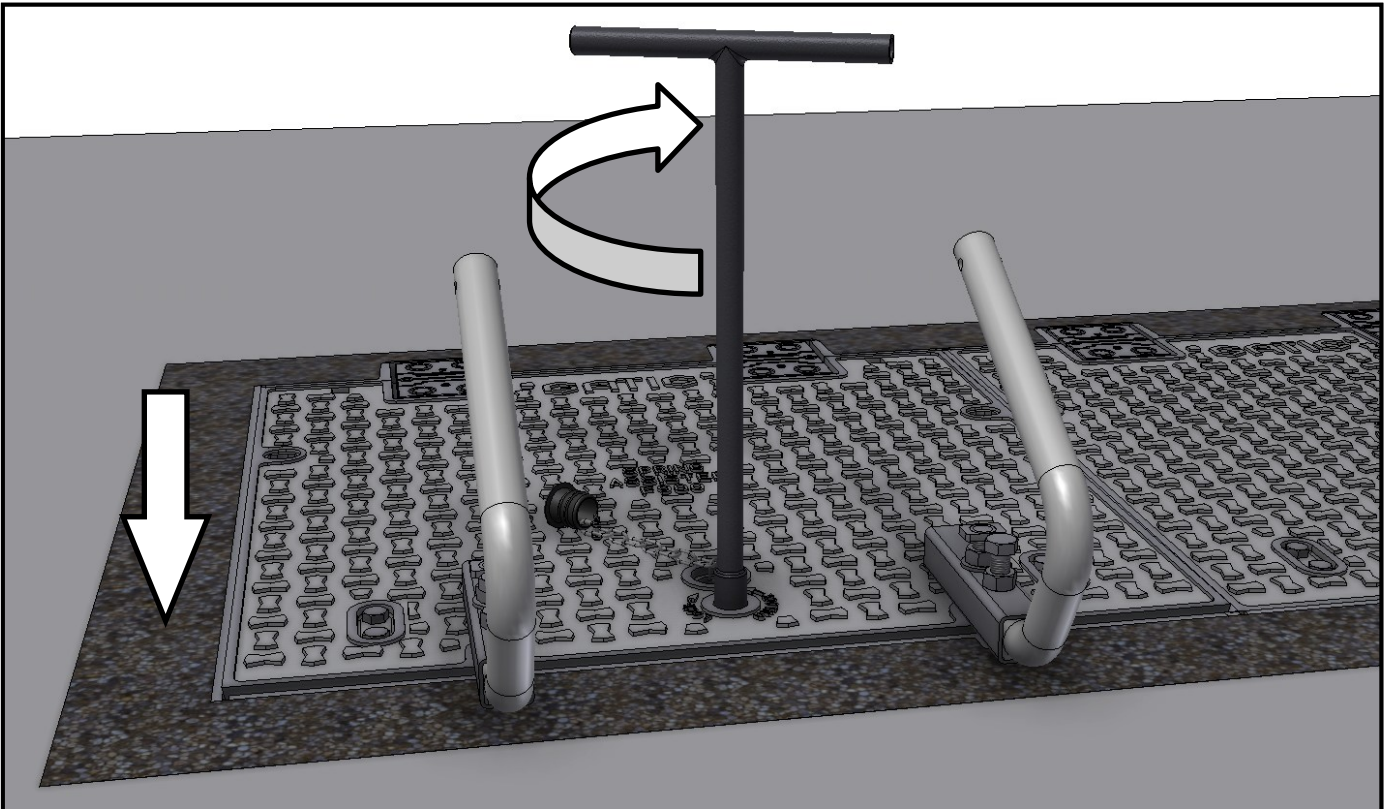

Ensure the cover is flush and the locking bolt is tight.

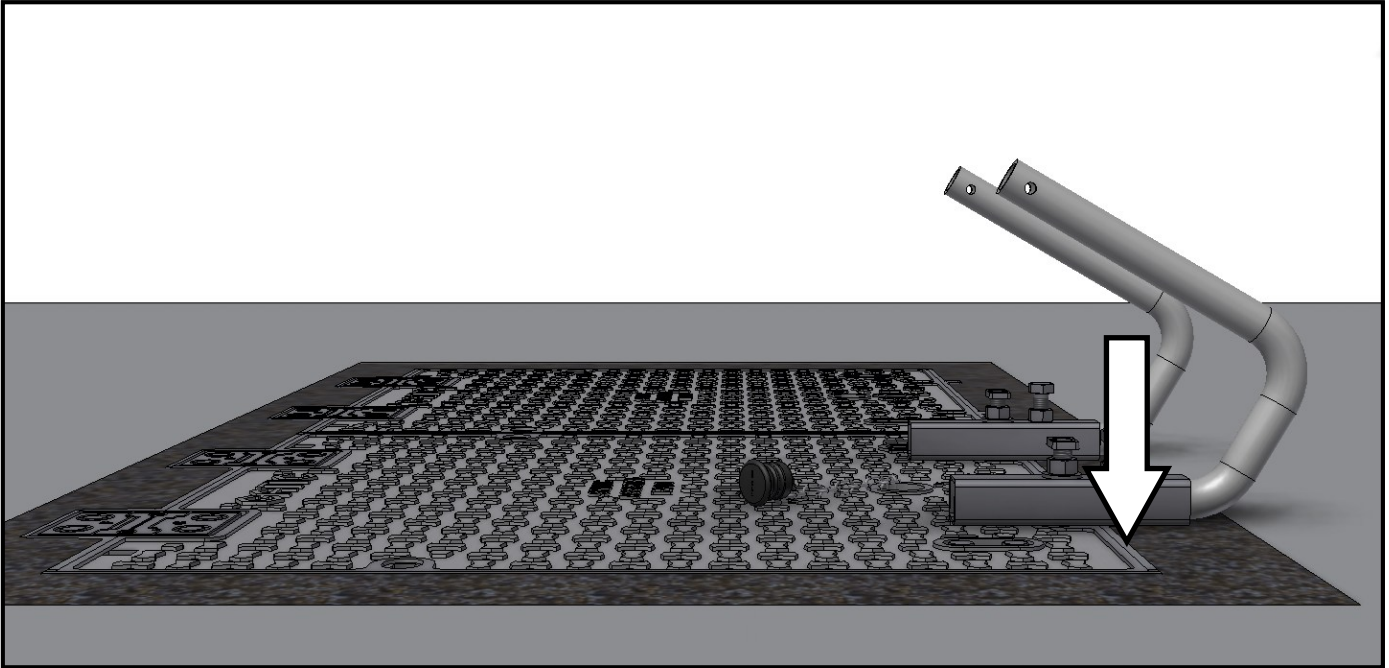

17. Remove the Short Handle Lifting Keys

1. Using the spanner provide, rotate the locking nut anti-clockwise until the lifting key loosens.
2. Rotate the top of the keyway key 90 degrees. This will disengage the key in the keyway allowing the lifting key to be removed..

Please refer to Gatic brochure for additional information on lifting key installation

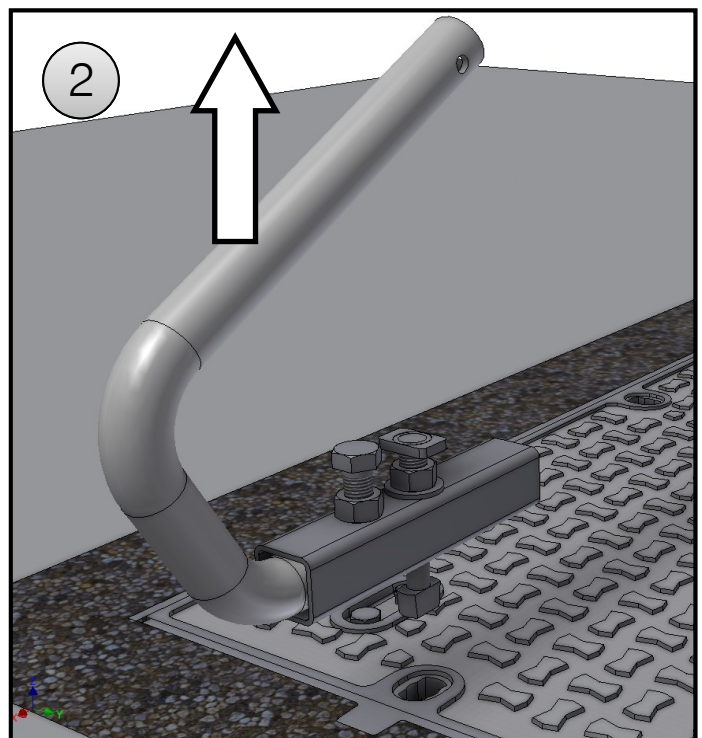
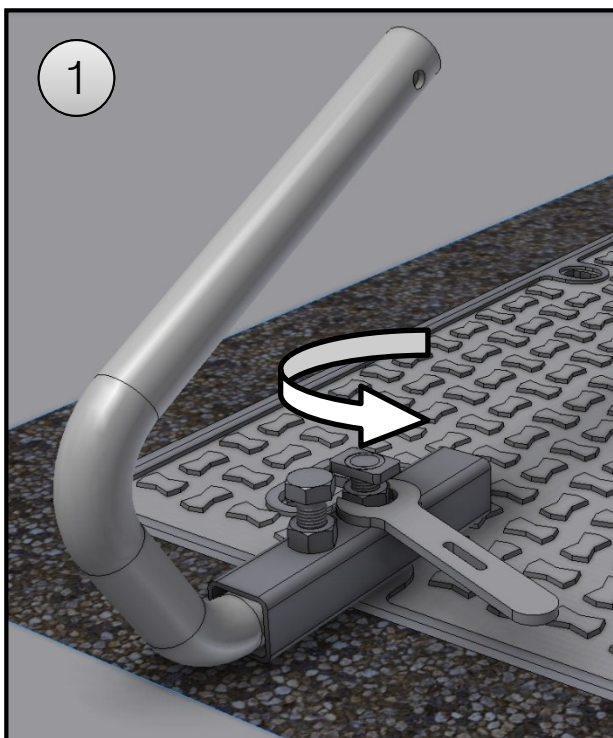

18. Grease & Secure Rubber Bung

Before feeding the chain through the cover apply a graphite based grease to the bung recess area (1), locking bolt recess area (2) and bracket bolt recess areas (3). Once the grease has been applied, the chain and rubber bung can be secured back in the recessed bung area.

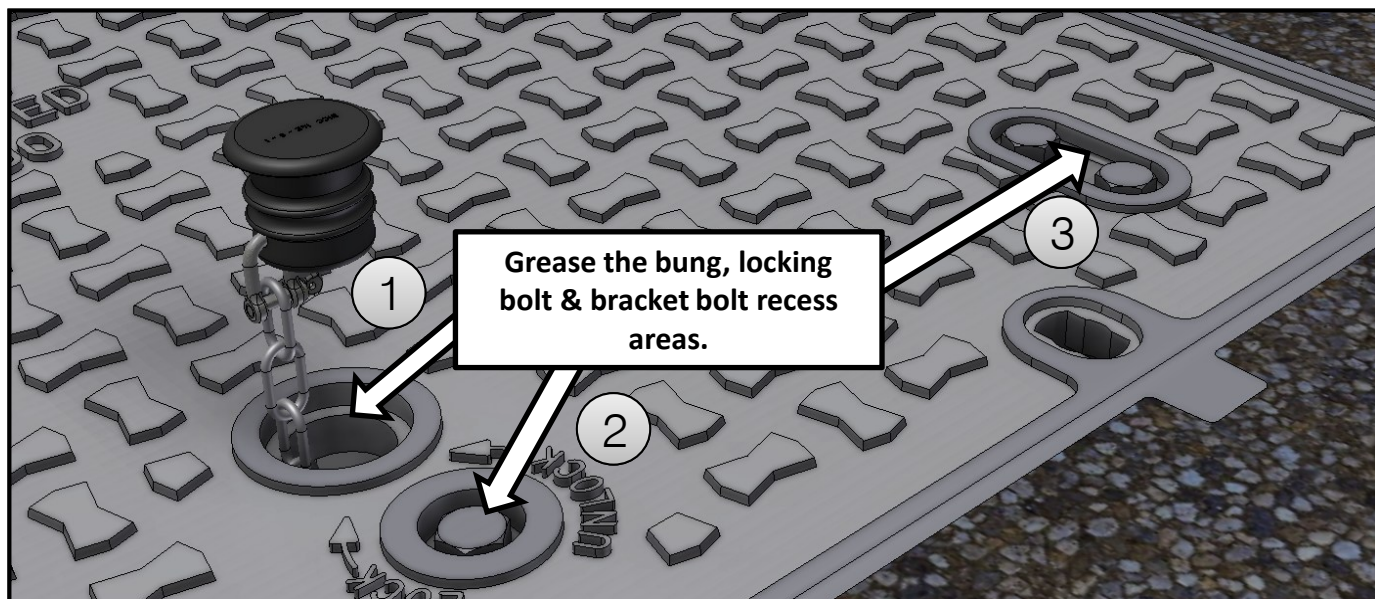

19. Replace the Nylon Keyhole Plugs.

Finally re attach the keyway plugs.

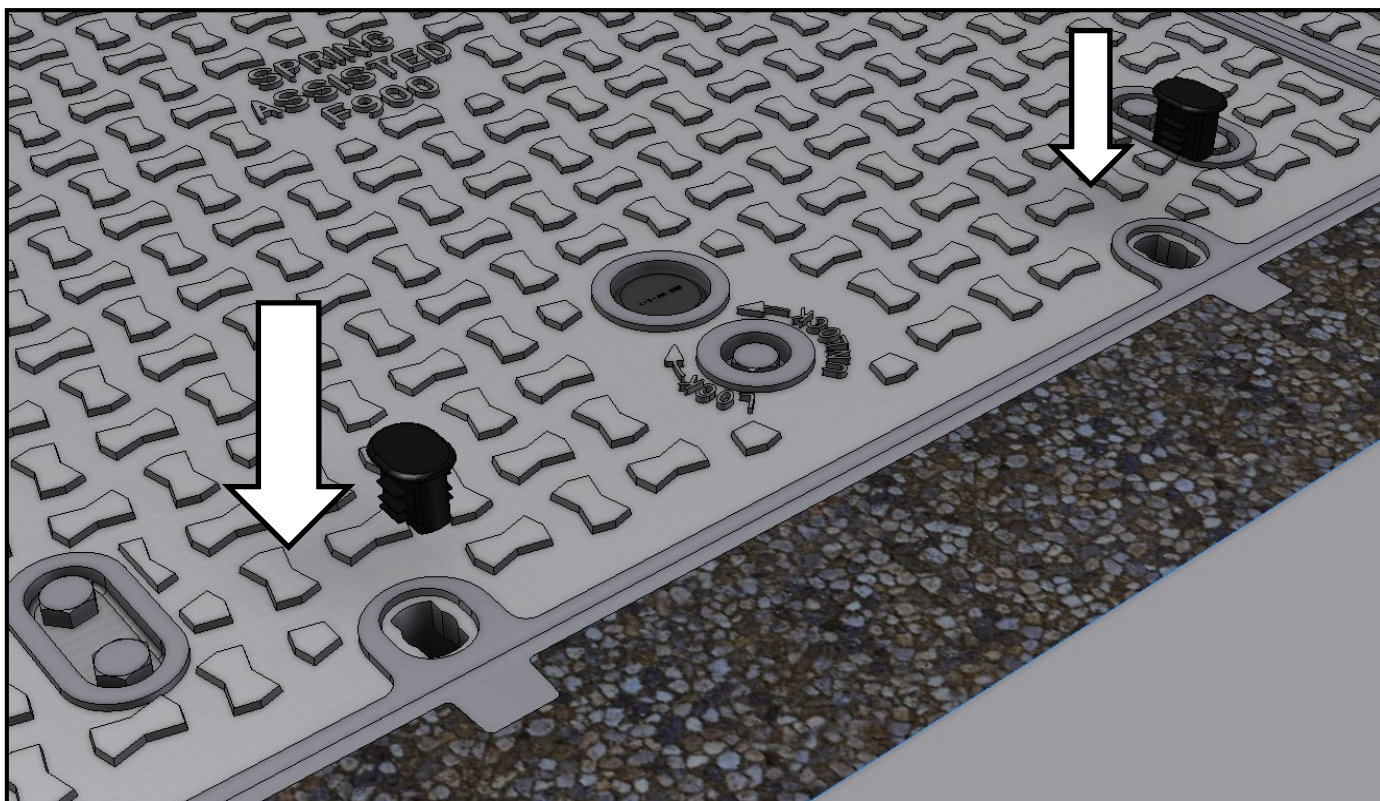

20. Repeat Operating Procedure as Necessary

After installation is complete, and whenever the cover is opened, apply good quality graphite based grease to all the seating faces of the cover, frame, the locking mechanism and bung before closing the cover.

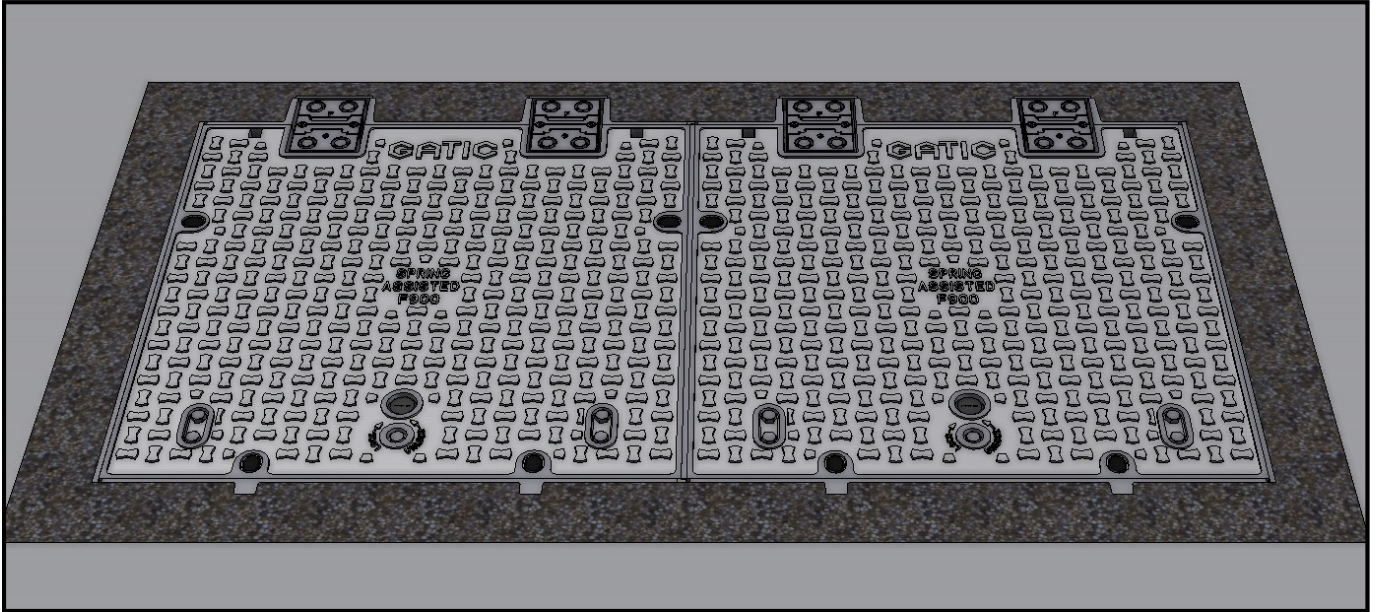

CONTACT

GATIC, Poulton Close, Dover, Kent, CT170UF
Tel: +44 (0) 1304 203545 Fax: +44 (0) 1304 215001
Email: info@gatic.com / Web: www.gatic.com